

Customer:		Ref.:	
Item	Quantity	Required flow	n.d.
Type	CENTRIFUGAL PUMP WITH HORIZONTAL SHAFT	Model	PMXT150/2A

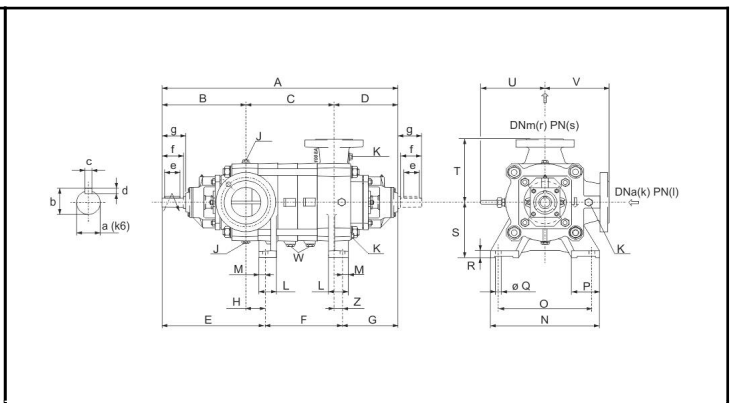
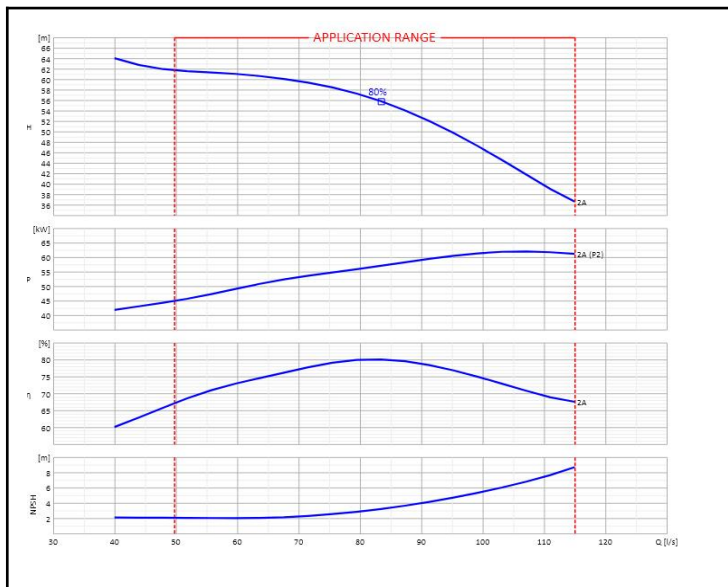

A	1190	K	G1/2	T	370	e	120
B	479	L	125	U	358	f	130
C	360	M	45	V	370	g	145
D	351	N	680	W	G1/4	k	200
E	619	O	590	Z	50	l	25
F	270	P	170	a	55	r	150
G	301	Q	24	b	59	s	40
H	140	R	40	c	16		
J	G3/4	S	315	d	10		

OPERATING DATA- ISO 9906:2012 3B -					CONSTRUCTION CHARACTERISTICS				
Q [l/s]	H [m]	P [kW]	η [%]	NPSH [m]	UNI delivery flange DN		150	PN	40
					UNI suction flange DN		200	PN	25
					Total weight		711		Kg
					No. Stages		2		
					Pump seal		Mechanical		
					Type of installation		Horizontal		

OPERATING LIMITS			OPERATING CHARACTERISTICS			
Pumped liquid	Water		Service flow rate		n.d.	n.d.
Max. temperature of pumped liquid	n.d.		Service head		n.d.	n.d.
Maximum density	1	kg/dm ³	Qmin	Qmax	49.72	115
Maximum viscosity	1	mm ² /s	H (Q=0)	Hmax (Qmin)	73	61.73
Max. solid content	0	g/m ³	P2 Duty Point	P2max	n.d.	61.97
Max. no. starts/hr	n.d.		Pump hydraulic efficiency		n.d.	n.d.
Maximum operating time with closed port	2min (3500 rpm) 6min (1450 rpm) [40 °C]		Rotation speed		1450	1/min
			Sense of rotation (*)		Clockwise	
			Number of pumps installed		Operating	Stand-by
					1	0

PUMP MATERIALS			
Delivery casing	Stainless steel		
Bearing support	Stainless steel		
Impeller	Stainless steel		
Suction casing	Stainless steel		
Pump shaft	Stainless steel		
Bearing flange	Stainless steel		
Diffuser	Stainless steel		
Casing	Stainless steel		
Impeller wear ring	Stainless steel		
Drum wear ring	Stainless steel		
Tie rod	Stainless steel		
Shaft sleeve	Stainless steel		
V seal ring	Rubber		
Bearing	Stainless steel		
OR seal ring	Rubber		

Notes:	(*) View from motor coupling side		
OFFER No.	Pos.	Date 17/01/2020	